

1

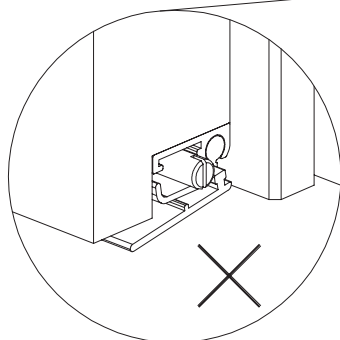

**WARNING !**

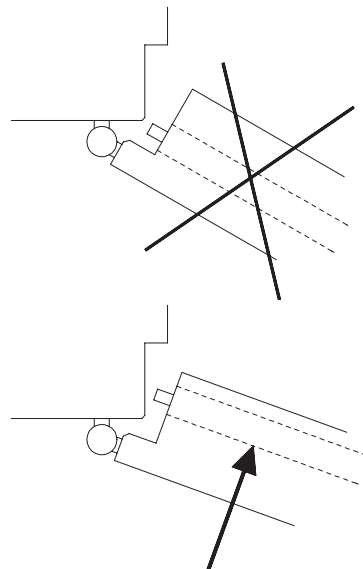
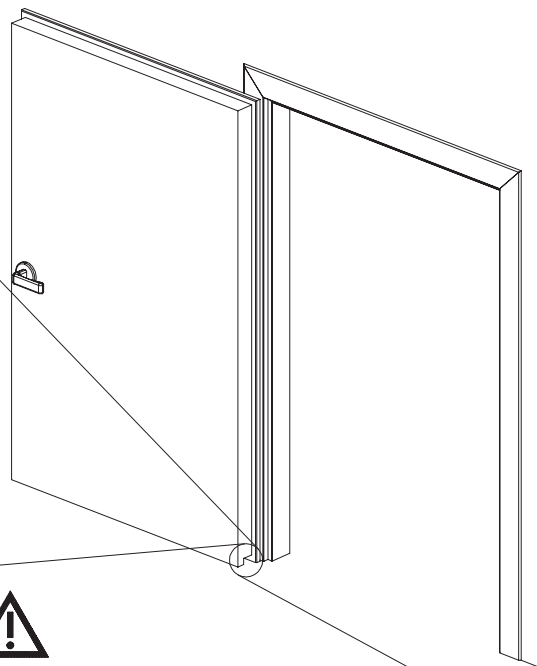
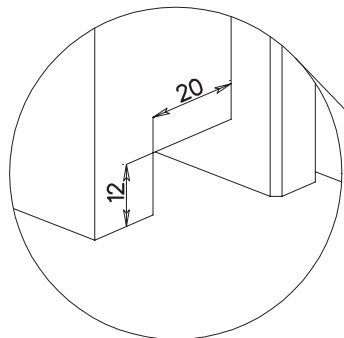
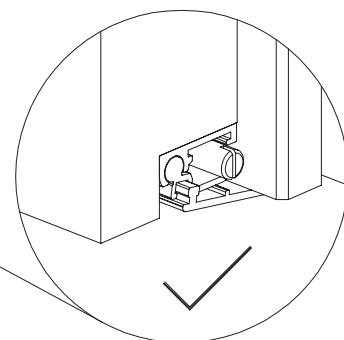

2

Sx

Trasformazione da Dx a Sx

1

Dx

Sfilare il pulsante di spinta (posizione 1)  
Inserire il pulsante di spinta nel lato opposto (posizione 2)

L	A
330	90
430	160
530	220
630	240
730	290
830	340
930	390
1030	440
1130	490
1230	540
1330	590
1430	640

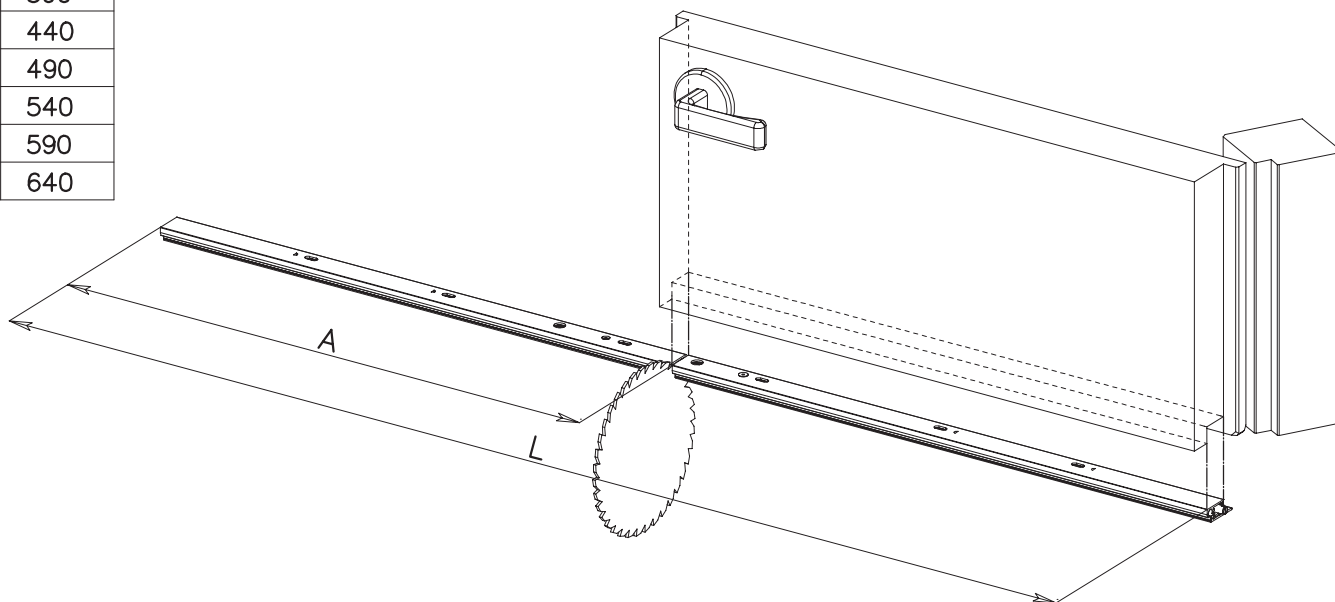

2

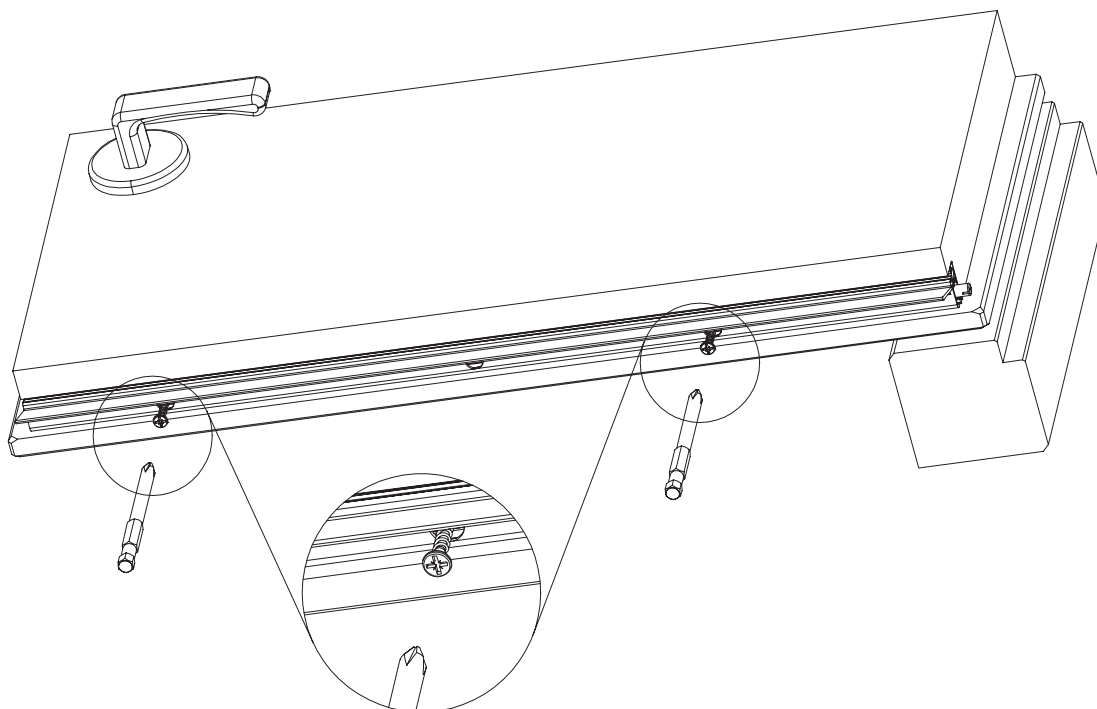

3

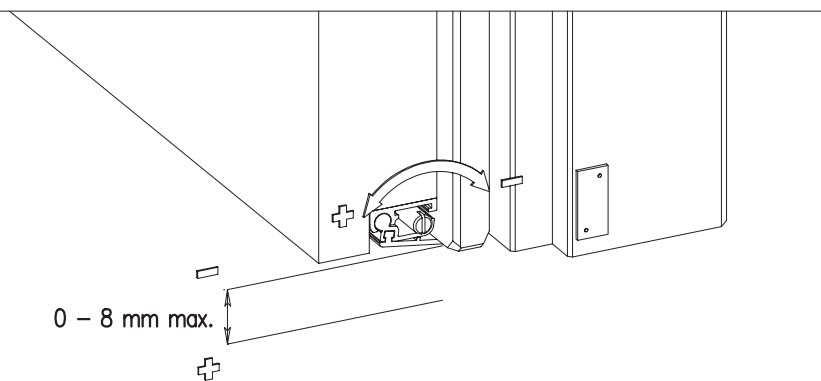

A

Soluzione di continuita' per nodo centrale 2 ante

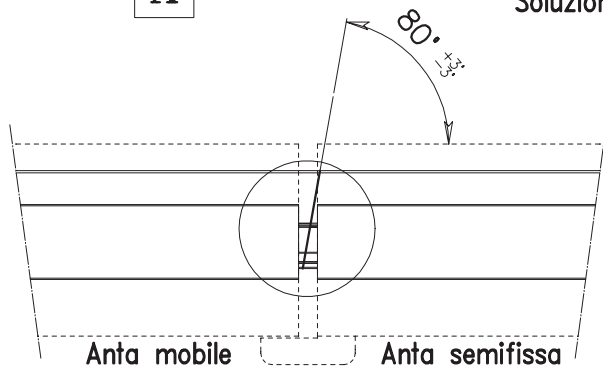
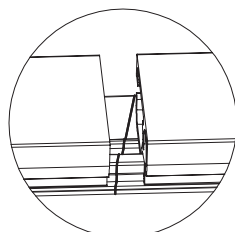

fig. 1A



Lasciare che le guarnizioni debordino di 10mm circa dai rispettivi profili di sostegno  
 Tagliarle, approssimativamente, con un angolo come da fig. 1A  
 Verificarne, ad ante chiuse, il corretto contatto  
 Attenzione alla corretta angolazione tra anta semifissa e mobile